

CUSTOM BRAKE WHEELS

G.W. Becker, Inc. brake wheels are machined from ductile iron castings. Experience has proven this high strength material to have excellent resistance to scoring and compatibility with a variety of friction materials. All wheel castings are completely machined to provide proper balance at normal operation speeds. The combination of machine balancing and ductile iron castings provides even and smoothly worn wheels and linings.

Brake wheels are furnished semi-finished with the hub rough bored for final machining by the customer. G.W. Becker, Inc. can also supply totally machined wheels to the customer specifications, including straight or tapered bore with keyways; straight bored hubs with double setscrews; tapered bored hubs with lock-washer slots, if required.

G.W. Becker, Inc. manufactures a wide variety of wheels for most sizes and types of braking systems including hydraulic, electrical, and mechanical. Non-standard size wheels, wheels made with carburized steel, and brake wheel couplings are also available.

Complete the specifications section and contact us by phone, fax or email for price and availability.

DIMENSIONS REQUIRED FOR ORDERING WHEELS

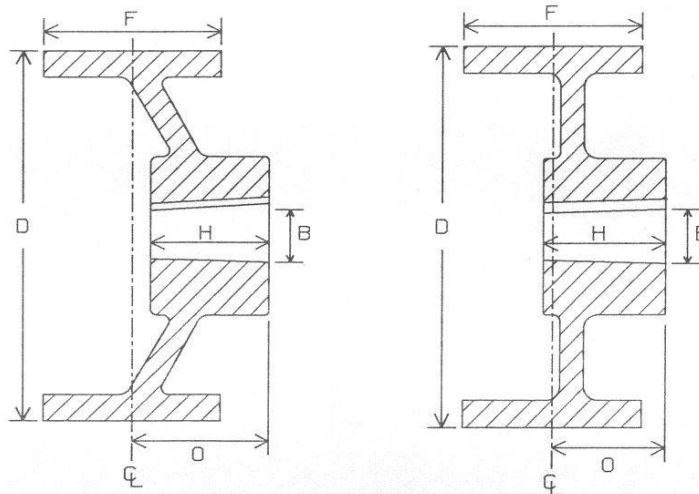

"D" WHEEL DIA.	"F" FACE WIDTH	"O" HUB OFFSET	"H" HUB LENGTH	"B" BORE DIA.	BORE TAPER IN/FT	"S" KEYWAY WIDTH	"T" KEYWAY DEPTH

BORE AND KEYWAY MACHINING

- For Machining wheel bores and keyways, give complete shaft data.
- For tapered shafts, don't forget the "taper per foot"
- For bores provide complete keyway dimensions and advise if gib key, or keeper plate will be used to hold wheel onto shaft.
- For standard AISE-NEMA DC or AC wound rotor motors, only the motor information is required.
- For NON-STANDARD motors and special wheels, please complete the specifications sheet.

Standard straight bores are manufactured within a tolerance of -0.001 inch. For tapered bores the tolerance is -0.005 inch. The standard taper is 1.250 inches per foot on diameter. The keyway tolerance is +0.005 inch on the width and +0.016 inch on the depth.

CRANE • PARTS • SERVICE • INSPECTIONS